

TAV.01 — LOCALITA': MARCONIA

AREA: Piazza Elettra—via S.G. Bosco



LEGENDA:

N°	SUPERFICI (mq)
1	3,00x4,00
2	4,00x6,00

RAPPR. GRAFICA: 1:500

TAV.02 – LOCALITA': MARCONIA

AREA: Piazza Mercato Coperto–via Potenza–via S.G. Bosco

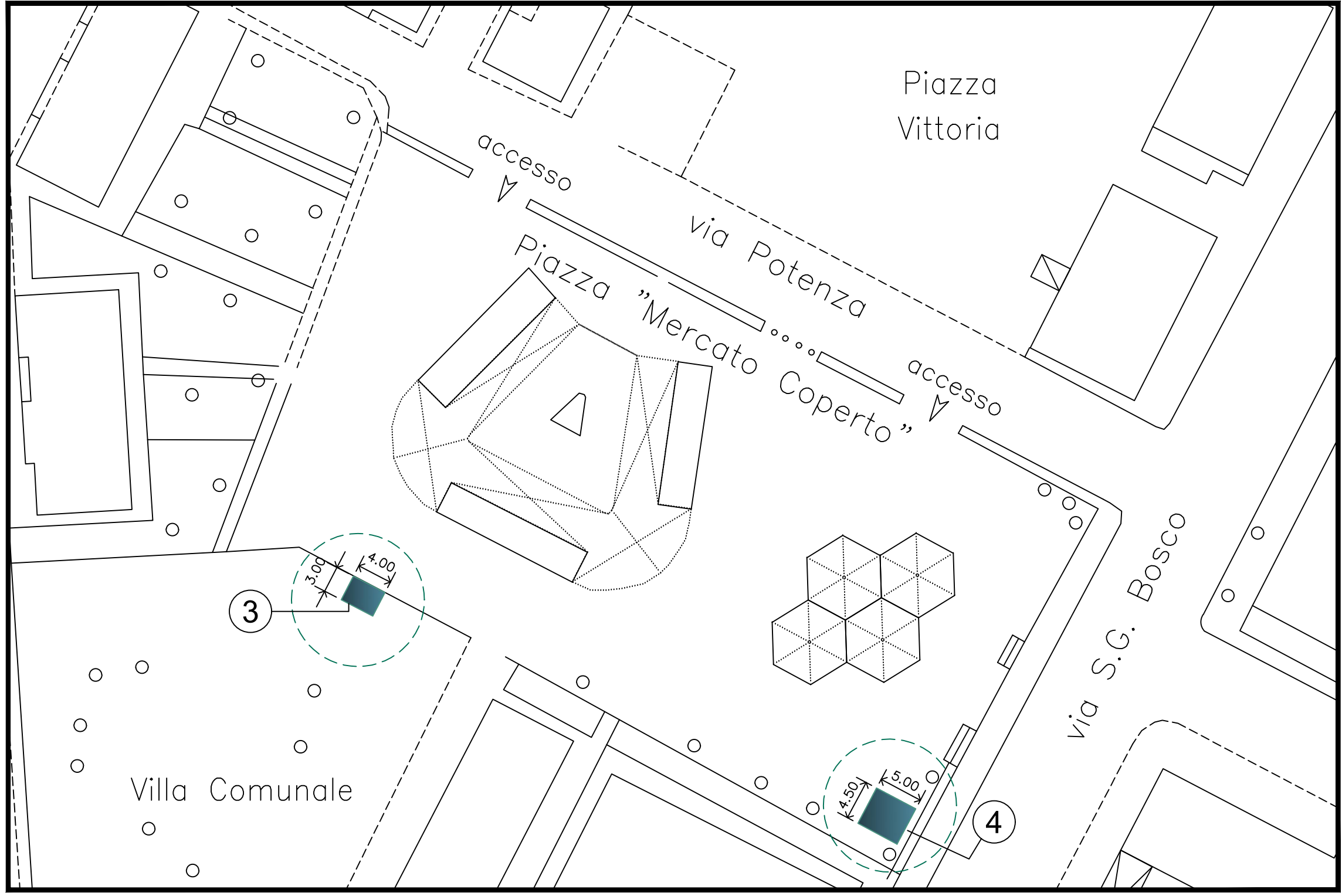

LEGENDA:

N°	SUPERFICI(mq)
3	3,00x4,00
4	4,50x5,00

RAPPR. GRAFICA: 1:500

TAV.03 – LOCALITA': MARCONIA
 AREA: Parco Giochi "Renato Gioia"

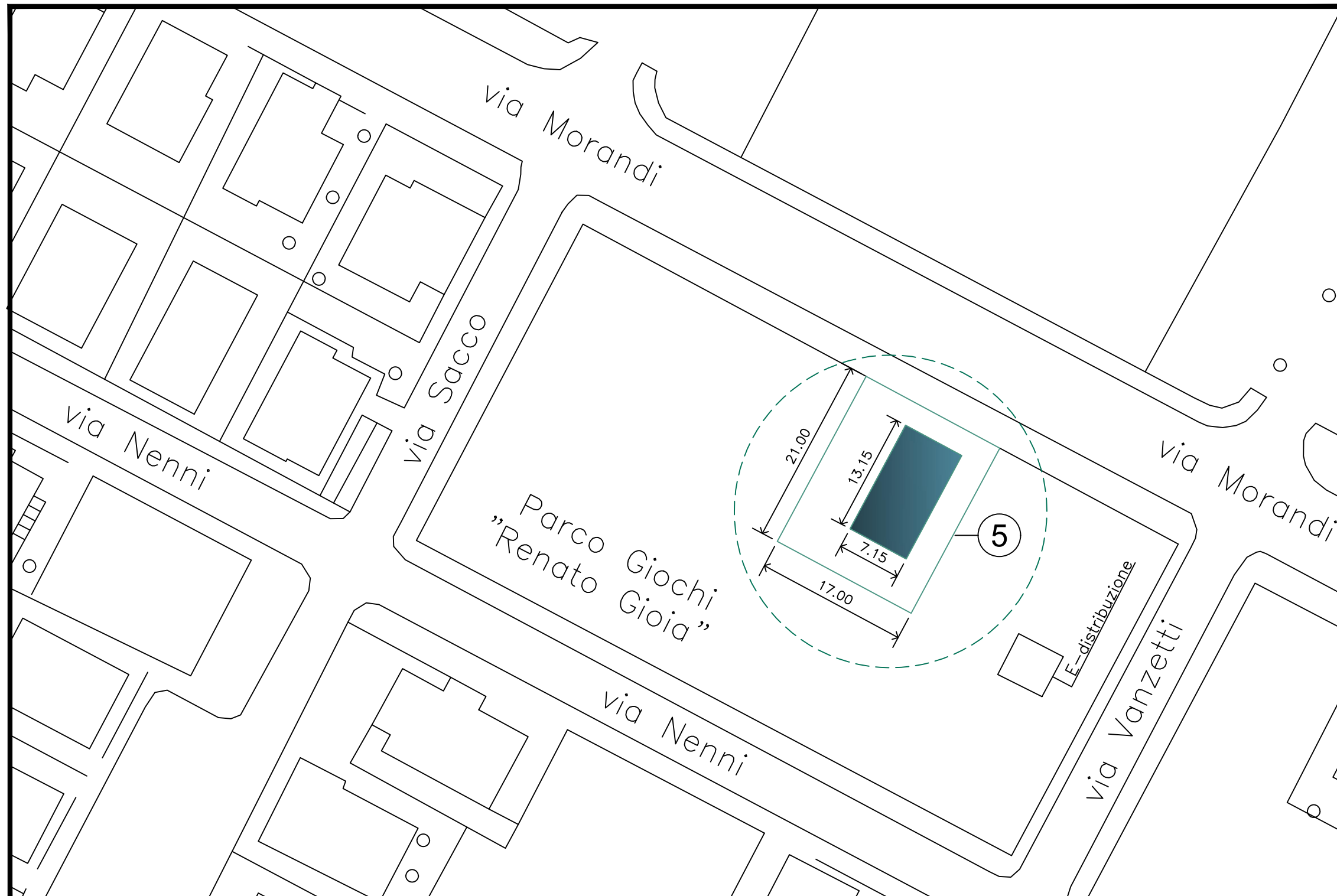

RAPPR. GRAFICA: 1:500

LEGENDA:

N°	SUPERFICI (mq)
5	17,00x21,00 (area ingombro)
	13,15x 7,15 (manufatto)

TAV.04 – LOCALITA': PISTICCI

AREA: Piazza Umberto I

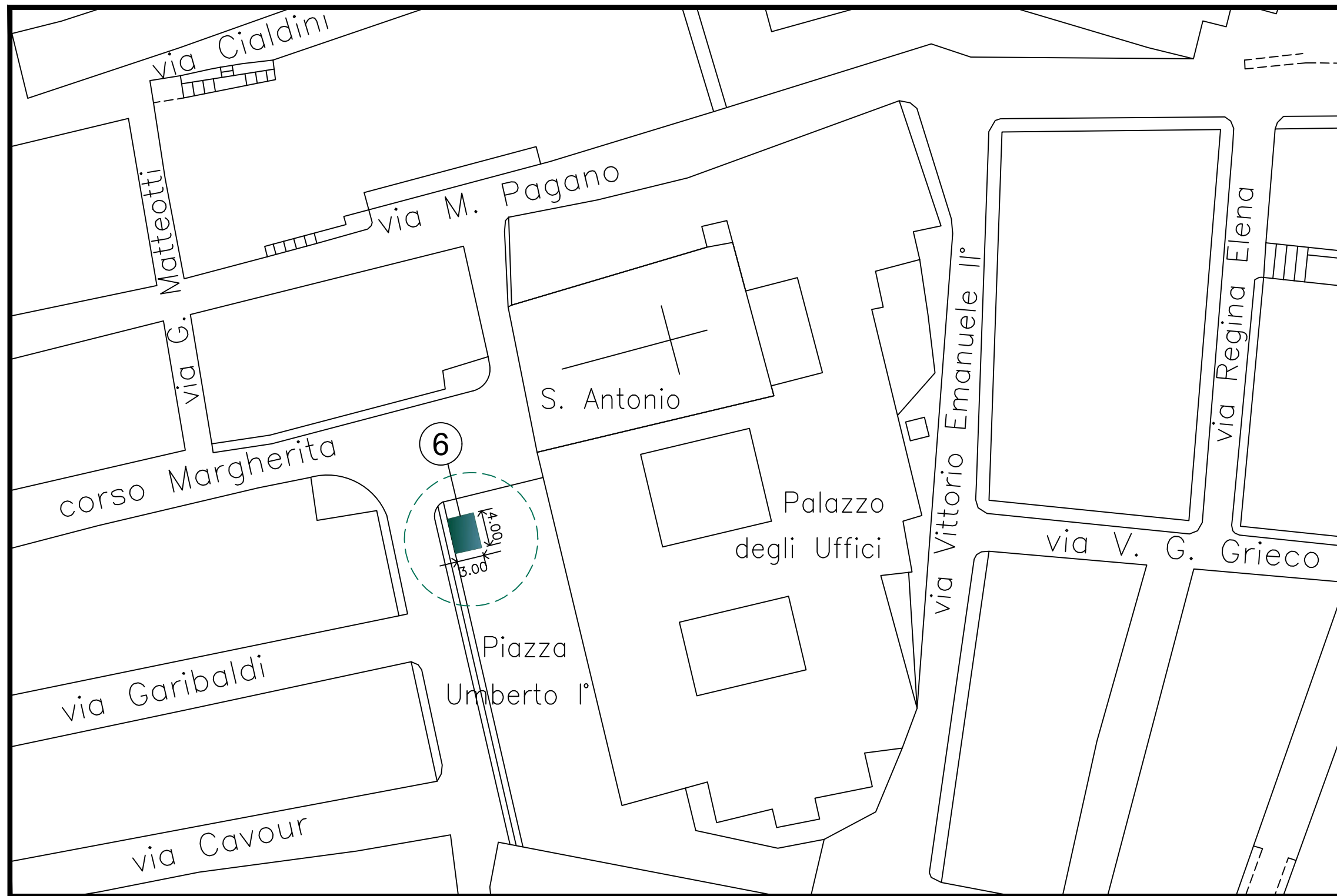

LEGENDA:

N°	SUPERFICI (mq)
6	3,00x4,00

RAPPR. GRAFICA: 1:500

TAV.05 – LOCALITA': PISTICCI

AREA: Piazzale Chiesa Madre

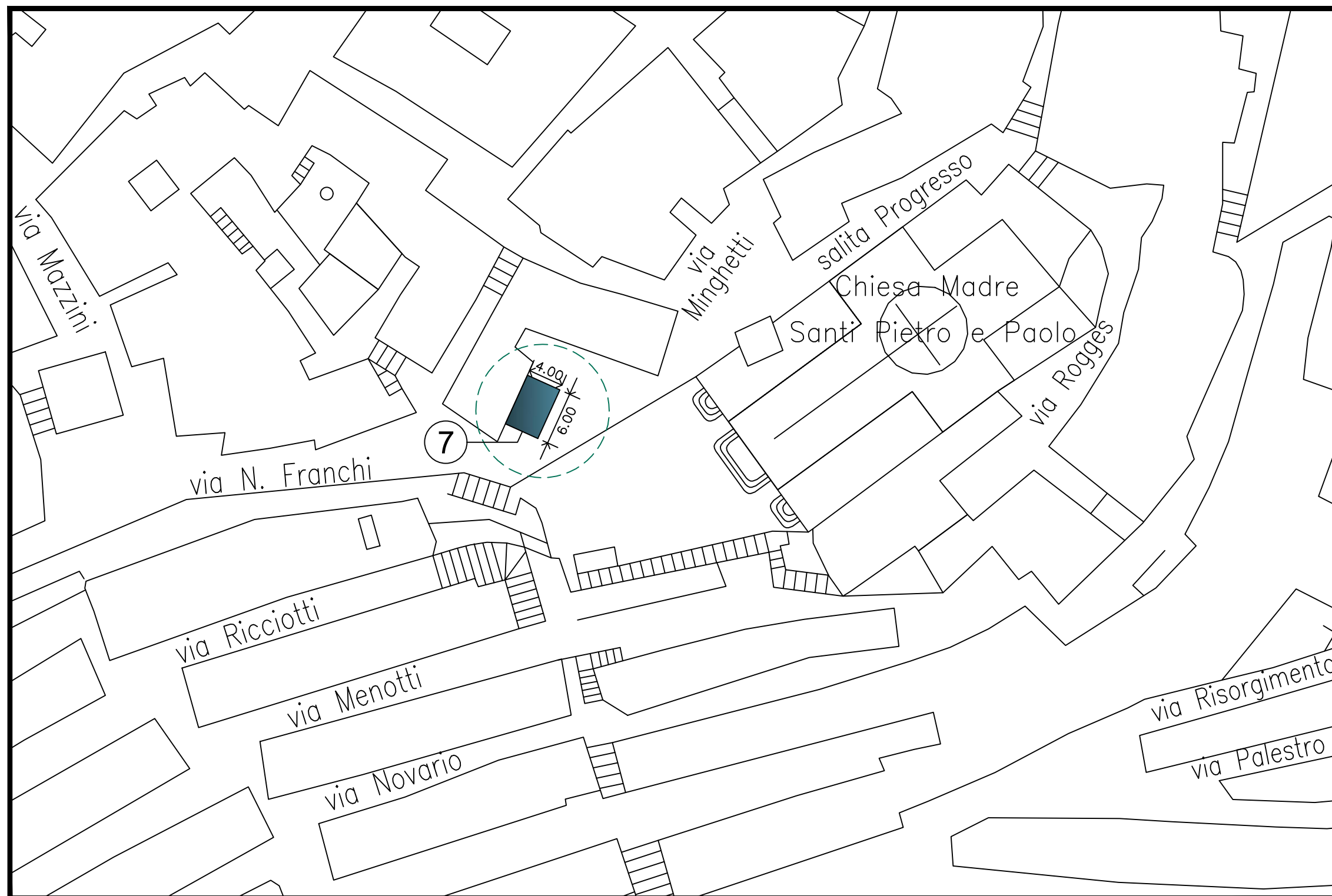

RAPPR. GRAFICA: 1:500

LEGENDA:

N°	SUPERFICI
7	4,00x6,00

TAV.06 – LOCALITA': PISTICCI

AREA: Piazza Johnny Lombardi

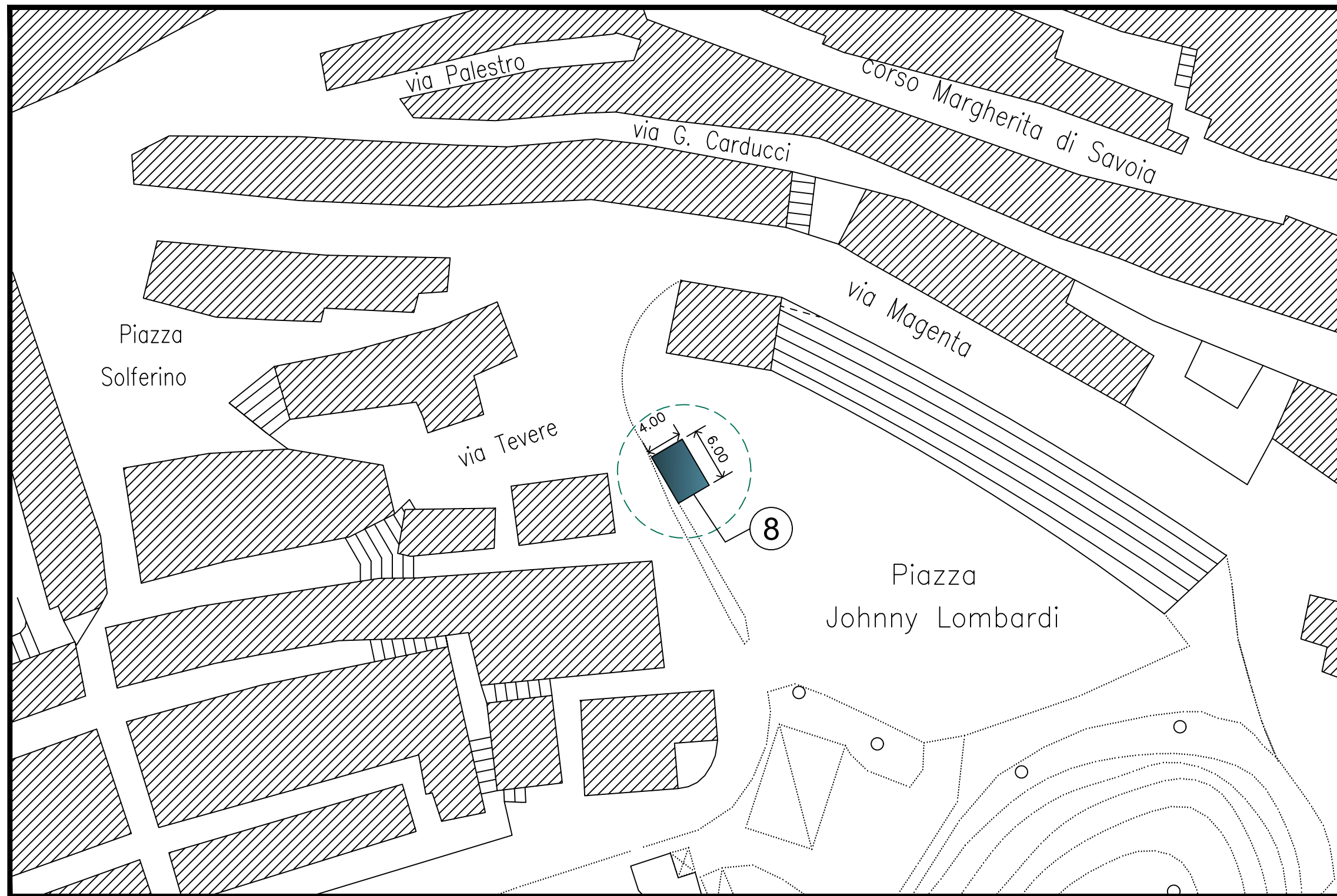

LEGENDA:

N°	SUPERFICI
8	4,00x6,00

RAPPR. GRAFICA: 1:500

TAV. 07 – LOCALITA': PISTICCI

AREA: Via Carlo Cattaneo

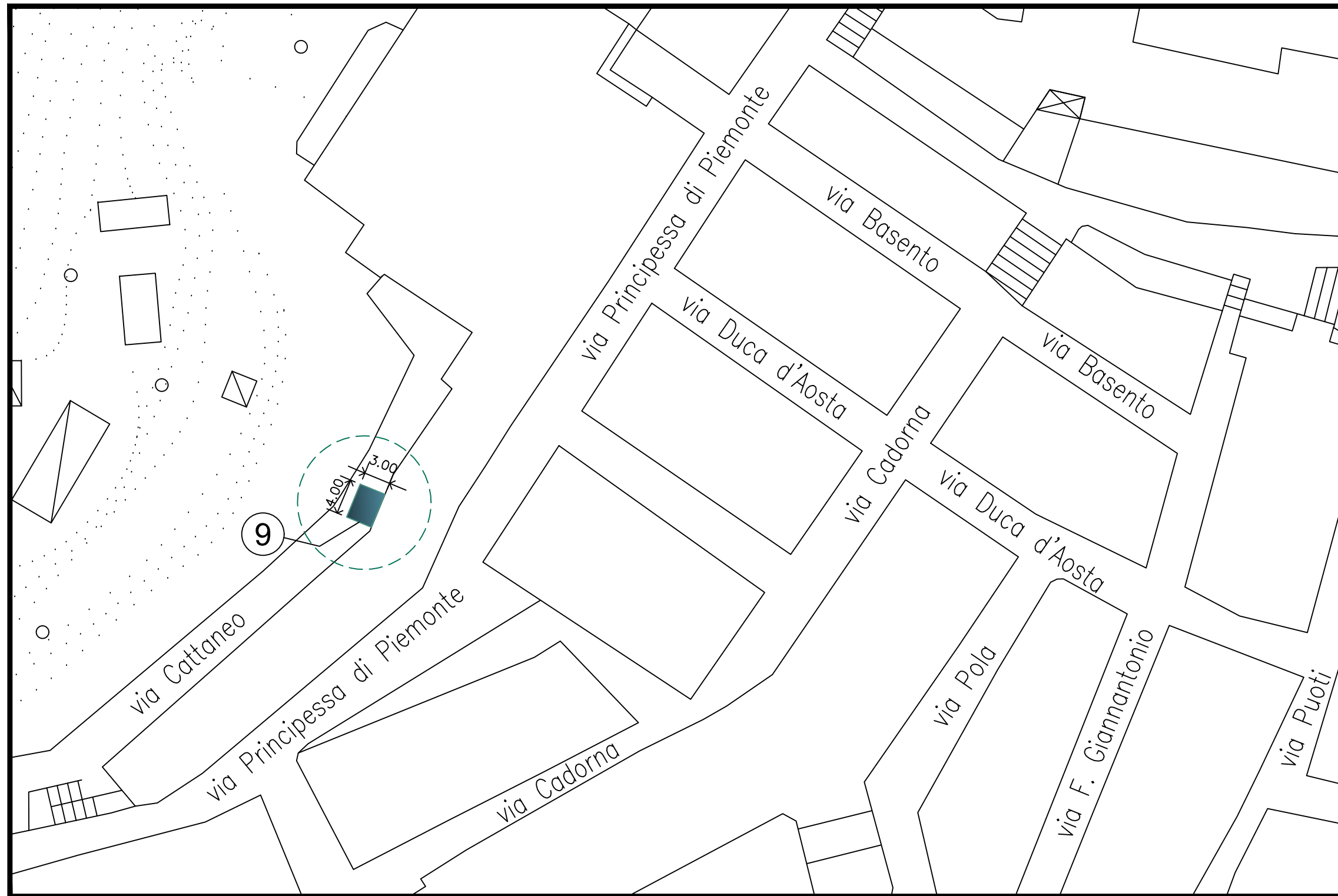

LEGENDA:

N°	SUPERFICI
9	3,00x4,00

RAPPR. GRAFICA: 1:500

TAV. 08 – LOCALITA': PISTICCI

AREA: Villa Comunale

STRALCIO ORTOFOTO

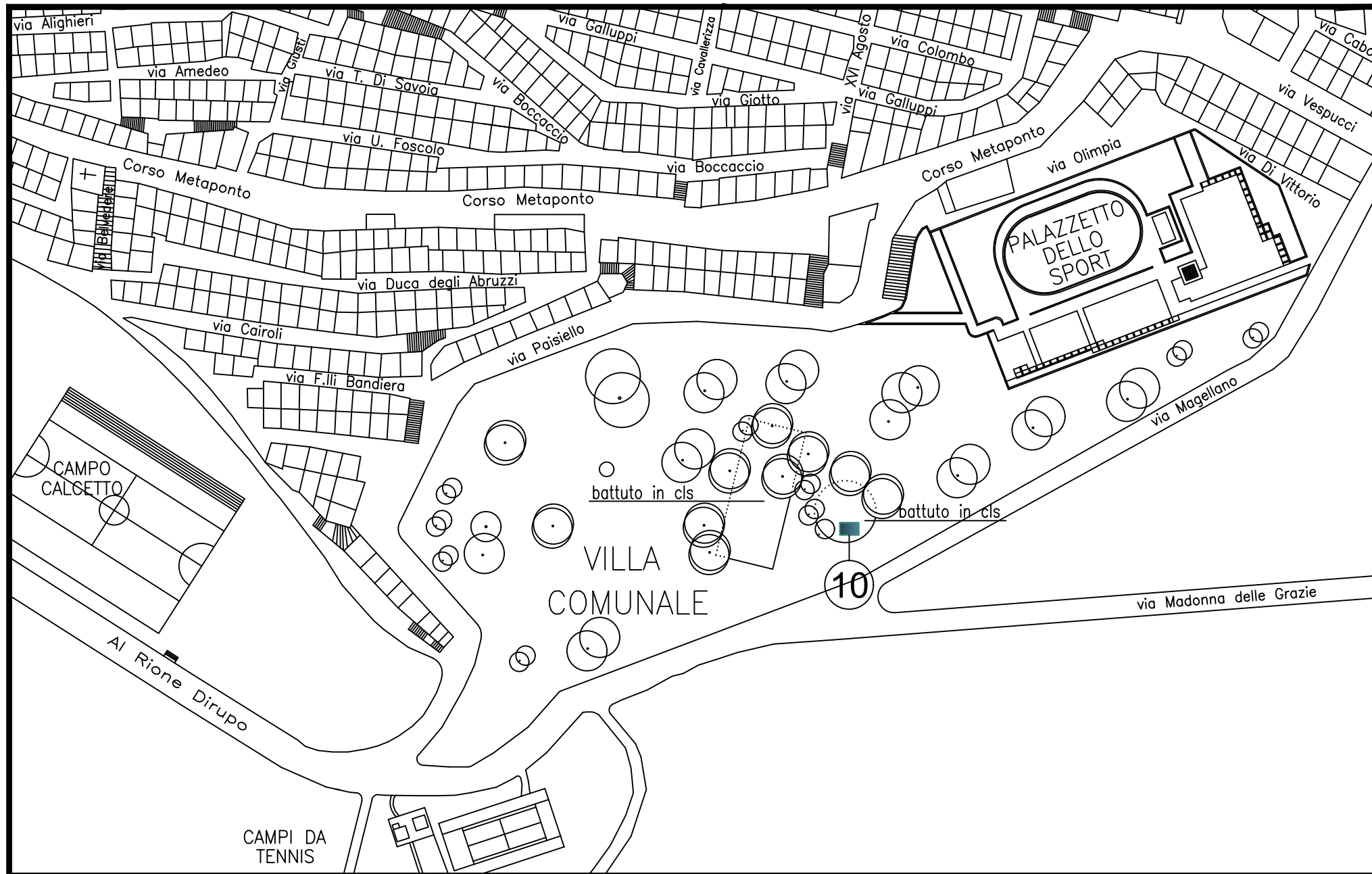

 AREA INTERESSATA

LEGENDA:

N°	SUPERFICI
10	3,00x4,00

TAV.09 – LOCALITA': MARCONIA

AREA: Cimitero Comunale

STRALCIO ORTOFOTO

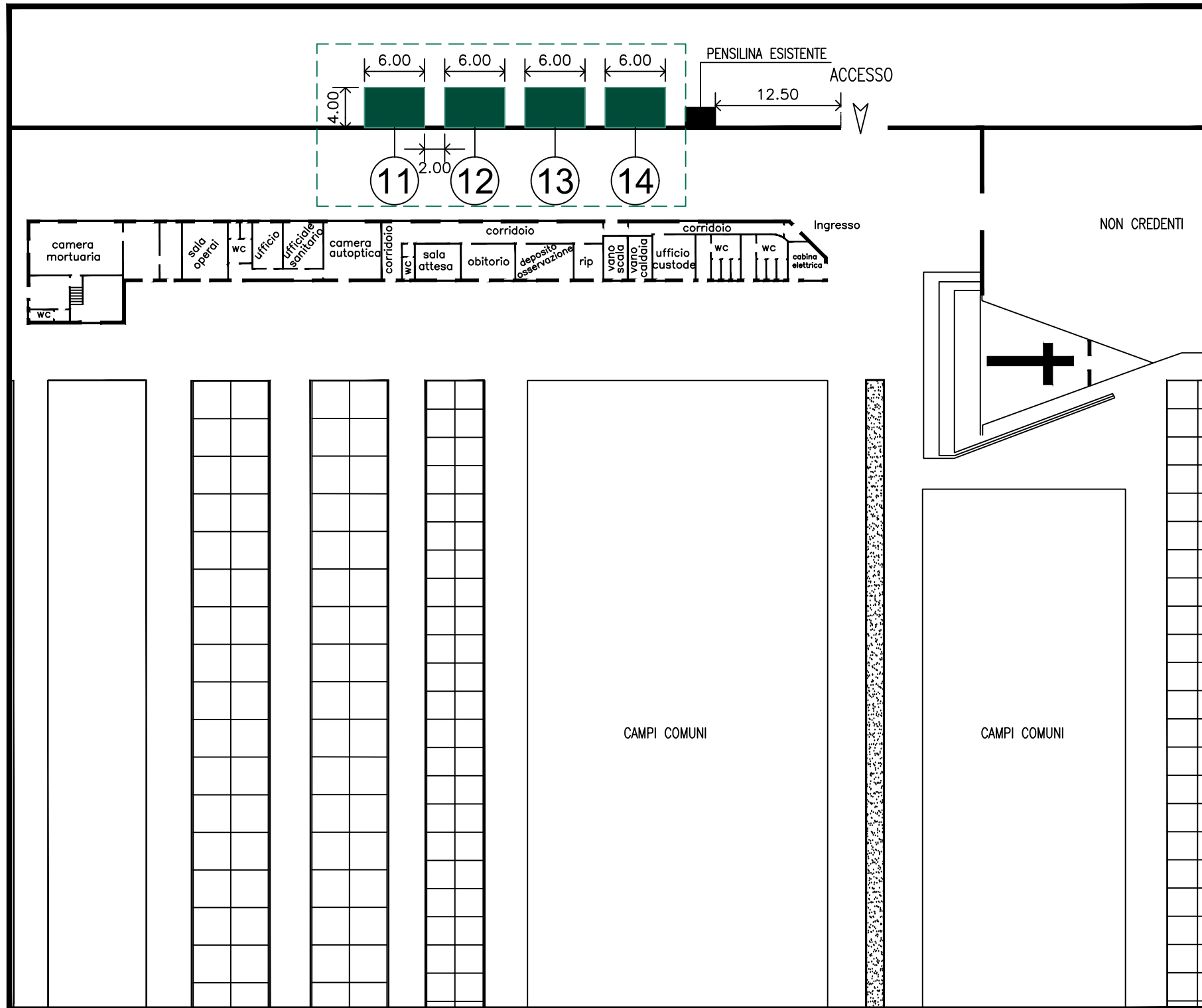

 AREA INTERESSATA

LEGENDA:

N°	SUPERFICI (mq)
11	4,00x6,00
12	4,00x6,00
13	4,00x6,00
14	4,00x6,00

TAV.10 – LOCALITA': PISTICCI

AREA: Cimitero Comunale

STRALCIO ORTOFOTO



 AREA INTERESSATA

LEGENDA:

N°	SUPERFICI (mq)
15	4,00x6,00
16	4,00x6,00
17	4,00x6,00
18	4,00x6,00

RAPPR. GRAFICA: 1:500